

BEAM ADJUSTMENT

200mW Red Crane Warning Laser

WARNING:

READ CAREFULLY BEFORE OPERATING. RETAIN THESE INSTRUCTIONS FOR FUTURE REFERENCE.

CRITICAL SAFETY INSTRUCTIONS:

Lasers can be hazardous and have unique safety considerations. Permanent eye injury and blindness is possible if lasers are used incorrectly. Pay close attention to each safety REMARK and WARNING statement in the user manual. Read all instructions carefully BEFORE operating this device.

- Avoid direct eye contact with laser light. Never intentionally expose your eyes or others to direct laser light.
- This laser product can potentially cause instant eye injury or blindness if laser light directly strikes the eyes.
- It is illegal and dangerous to shine this laser into audience areas, where the audience or other personnel could get direct laser beams or bright reflections into their eyes.
- There are no user serviceable parts inside the unit. Do not open the housing or attempt any repairs yourself. In the unlikely event your unit may require service, please contact the manufacturer.
- Use of controls or adjustments or performance of procedures other than those specified herein may result in hazardous radiation exposure.

INSTALLATION

These crane warning lasers feature a small profile and are lightweight, making them ideal for use in locations where traditional lights cannot fit or would block other mounted equipment.

Mount the adjustable U-bracket with the predrilled mounting thru-hole at the base.

The thru-hole bolt mounting design allows operators to rotate the bracket after mounting to accommodate any required mounting angle. To do this, simply loosen the mounting bolt, adjust the angle of the mounting bracket to the ideal position and then retighten the bolt.

The U-bracket on the LZRWL-CRN also allows the laser to be oriented 180° vertically after mounting. This innovative mounting design allows this crane warning laser light to be an extremely versatile addition to workplace safety. See Rotating Beam for rotating laser beam.

WIRING

Voltage:12V DC.

Do not plug laser directly into High Voltage as damage will occur! Only use a power transformer or low voltage power source.

To rotate beam, loosen set screws holding laser to mount. Rotate entire laser module until desired angle is achieved and tighten set screws.



FOCUSING BEAM

1. Power laser and aim toward a flat surface.
2. Rotate lens to adjust beam until sharp. This can either be clockwise or counter-clockwise depending on its original position.

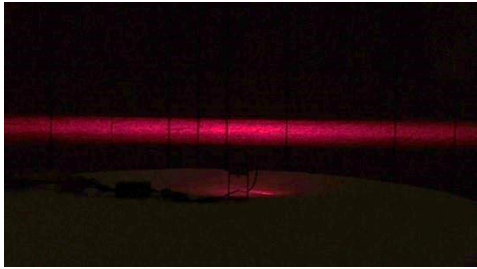

BEFORE

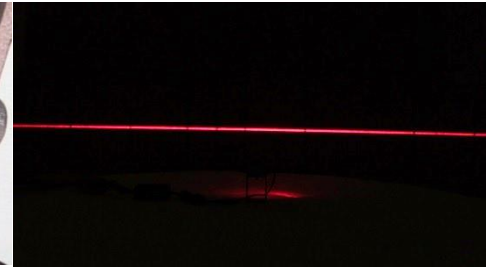
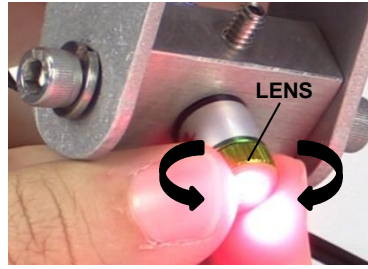

AFTER

3. Laser beam may no longer be horizontal after adjusting lens. To fix this, loosen set screws holding laser to mount. Rotate entire laser module until desired angle is achieved and tighten set screws.

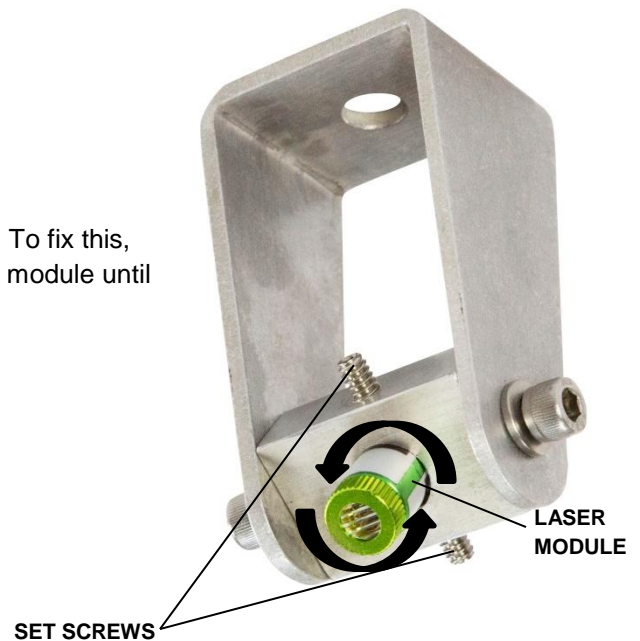

THESE INSTRUCTIONS MAY NOT COVER ALL DETAILS OR VARIATIONS OF THIS PRODUCT FOR YOUR EQUIPMENT OR INSTALLATION REQUIREMENTS. SHOULD FURTHER INFORMATION NOT COVERED BY THESE INSTRUCTIONS BE REQUIRED, PLEASE CONTACT LARSON ELECTRONICS BY EMAIL AT SALES@LARSONELECTRONICS.COM OR BY PHONE AT 1-800-369-6671 FOR FURTHER ASSISTANCE.

PLEASE VISIT LARSONELECTRONICS.COM FOR **WARRANTY** AND **RETURN** INFORMATION.